

REPLACEMENT PARTS SUITABLE FOR:
HYPERTHERM®

MAX 20® POWERMAX 350® POWERMAX 380®
--

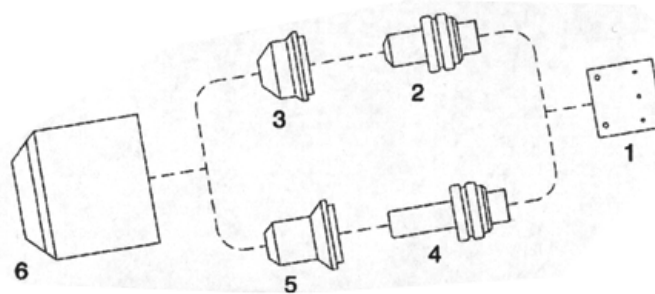

ITEM	CATALOG NUMBER	DESCRIPTION	STD. QTY
1	CS020239	SWIRL RING	5
2	CS020220	ELECTRODE	10
3	CS020299	TIP	10
4	CS020382	EXTENDED ELECTRODE	10
5	CS020381	TIP EXTENDED Ø.073 - .029	10
	CS120504	TIP EXTENDED Ø.081 - .032	10
6	CS020218	RETAINING CAP	2

MAX 40CS® / MAX 42® / MAX 43®

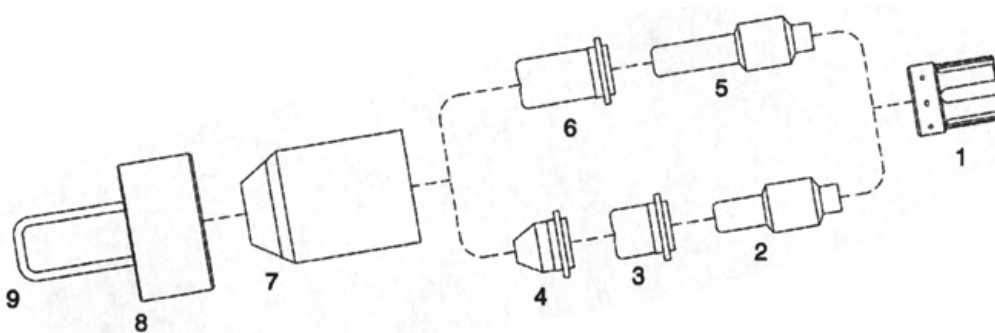

ITEM	CATALOG NUMBER	DESCRIPTION	STD. QTY
1	CS020361	SWIRL RING	2
2	CS120573	ELECTRODE (REPLACES CS020351)	10
3	CS020350	TIP (CASTLE) .038	10
	CS020395	TIP (CASTLE) .042	10
4	CS020542	TIP (PIPE)	10
5	CS120574	EXTENDED ELECTRODE (REPLACES CS020547)	10
6	CS020546	EXTENDED TIP	10
7	CS020930	RETAINING CAP	2
8	CS60311	SPACER WITH EXTENDED SPRINGS	2
9	CS60383	EXTENDED SPRINGS (FIT OVER CS60311)	20
N/S	CS51853	CIRCLE CUTTING ATTACHMENT	1
N/S	CS51809	CUTTING GUIDE	1

Ergodani is in no way affiliated with HYPERTHERM®. The parts advertised for sale are not genuine HYPERTHERM® parts, but are parts made for and by Ergodani. Reference to HYPERTHERM® machine, torches and numbers are for your convenience only. We reserve the right to substitute genuine HYPERTHERM® parts in place of Ergodani parts.

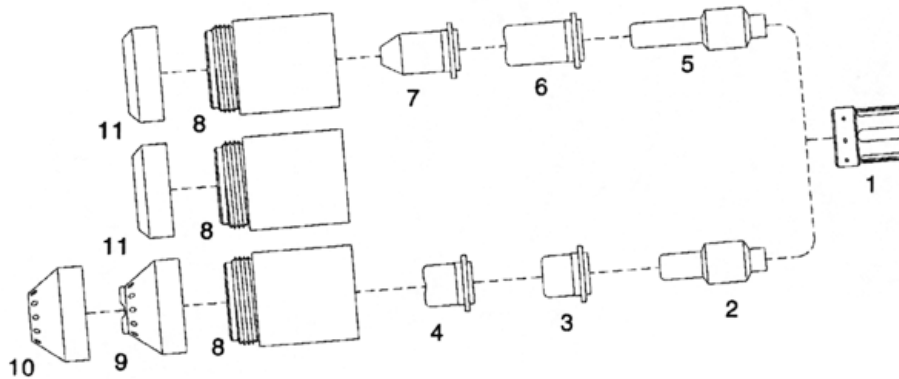
REPLACEMENT PARTS SUITABLE FOR:
HYPERTHERM®
POWERMAX 800®

ITEM	CATALOG NUMBER	DESCRIPTION	STD. QTY
1	CS020361	SWIRL RING	2
2	CS120573	ELECTRODE (REPLACES CS020351)	10
3	CS120438	TIP 40A	10
	CS120282	TIP 50A	10
4	CS020395	TIP 50A (CASTLE)	10
5	CS120574	EXTENDED ELECTRODE (REPLACES CS020547)	10
6	CS120304	EXTENDED TIP (CASTLE)	10
7	CS120305	EXTENDED TIP (PIPE)	10
8	CS120301	RETAINING CAP	1
9	CS120283	SHIELD (HAND)	2
10	CS120326	SHIELD (MACH)	2
11	CS120303	DEFLECTOR	5
N/S	CS51865	CIRCLE CUTTING ATTACHMENT	1
N/S	CS51804	CUTTING GUIDE	1

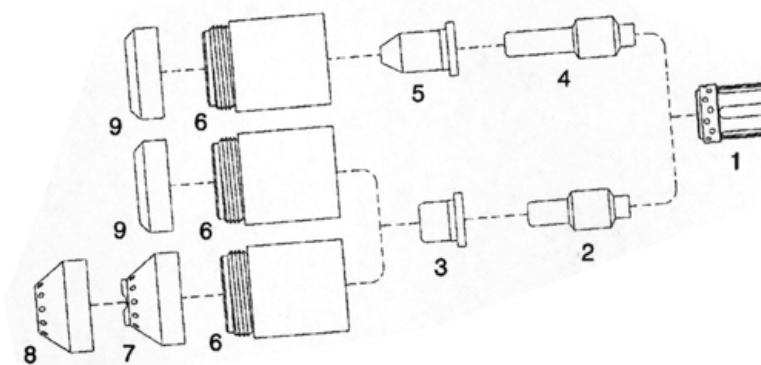
POWERMAX 900®

ITEM	CATALOG NUMBER	DESCRIPTION	STD. QTY
1	CS120576	SWIRL RING	2
2	CS120573	ELECTRODE	10
3	CS120577	TIP 55A	10
4	CS120574	EXTENDED ELECTRODE	10
5	CS120606	EXTENDED TIP 35A	10
	CS120578	EXTENDED TIP (PIPE)	10
6	CS120600	RETAINING CAP	1
7	CS120601	SHIELD (HAND)	2
8	CS120602	SHIELD (MACH)	2
9	CS120303	DEFLECTOR	5
N/S	CS51865	CIRCLE CUTTING ATTACHMENT	1
N/S	CS51804	CUTTING GUIDE	1

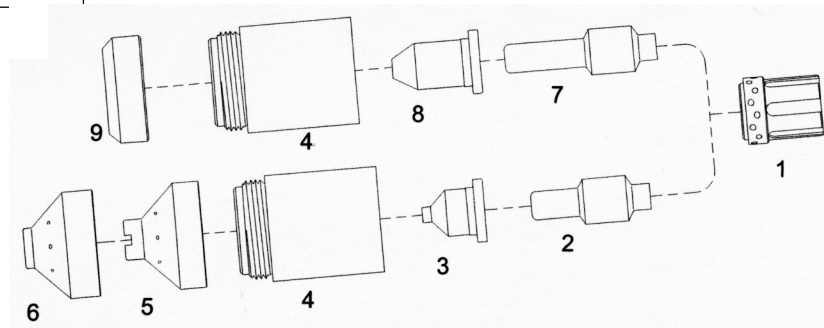
REPLACEMENT PARTS SUITABLE FOR:
HYPERTHERM®
POWERMAX 600®

ITEM	CATALOG NUMBER	DESCRIPTION	STD. QTY
1	CS120576	SWIRL RING	2
2	CS120573	ELECTRODE-HF	10
3	CS120826	TIP 40A	10
4	CS120600	CAP RETAINING	1
5	CS120828	SHIELD (HAND)	2
6	CS120827	SHIELD (MACHINE)	2
7	CS120574	EXTENDED ELECTRODE-HF	10
8	CS120606	TIP 35A EXTENDED	10
9	CS120303	DEFLECTOR	5
N/S	CS51865	CIRCLE CUTTING ATTACHMENT	1
N/S	CS51804	CUTTING GUIDE	1

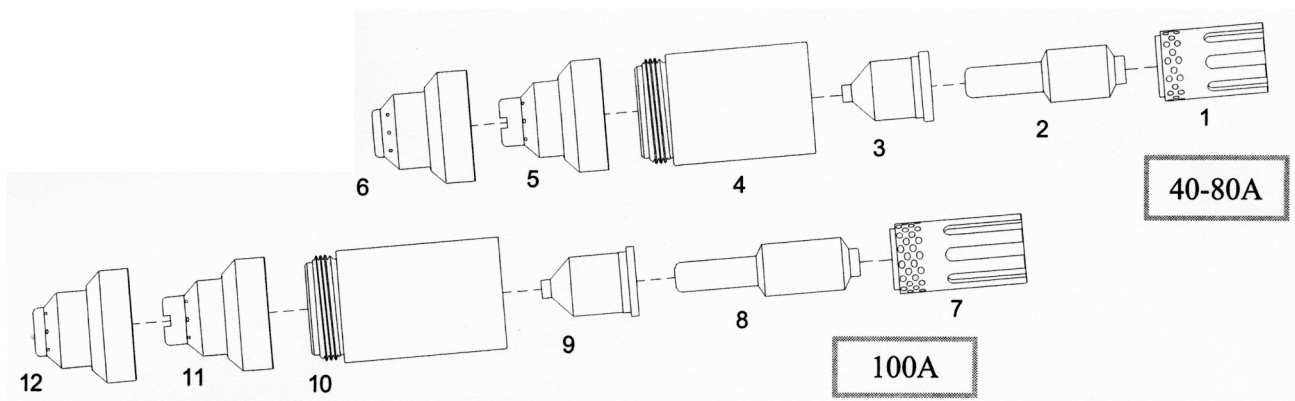
POWERMAX 1000® / POWERMAX 1250® / POWERMAX 1650®

ITEM	CATALOG NUMBER	DESCRIPTION	STD. QTY
1	120925	SWIRL RING	2
2	120926	ELECTRODE-HF	10
3	120932	TIP 40A	10
	120931	TIP 60A	10
	120927	TIP 80A	10
4	120928	CAP RETAINING	1
5	120929	SHIELD (HAND)	2
6	120930	SHIELD (MACHINE)	2
7	220051	SWIRL RING	2
8	220037	ELECTRODE-HF	10
9	220011	TIP 100A	10
10	220048	CAP RETAINING	1
11	220065	SHIELD (HAND)	2
12	220047	SHIELD (MACHINE)	2
N/S	CS51865	CIRCLE CUTTING ATTACHMENT	1
N/S	CS51804	CUTTING GUIDE	1

Ergodani is in no way affiliated with HYPERTHERM®. The parts advertised for sale are not genuine HYPERTHERM® parts, but are parts made for and by Ergodani. Reference to HYPERTHERM® machine, torches and numbers are for your convenience only. We reserve the right to substitute genuine HYPERTHERM® parts in place of Ergodani parts.

REPLACEMENT PARTS SUITABLE FOR:

HYPERTHERM®

MAX 40®

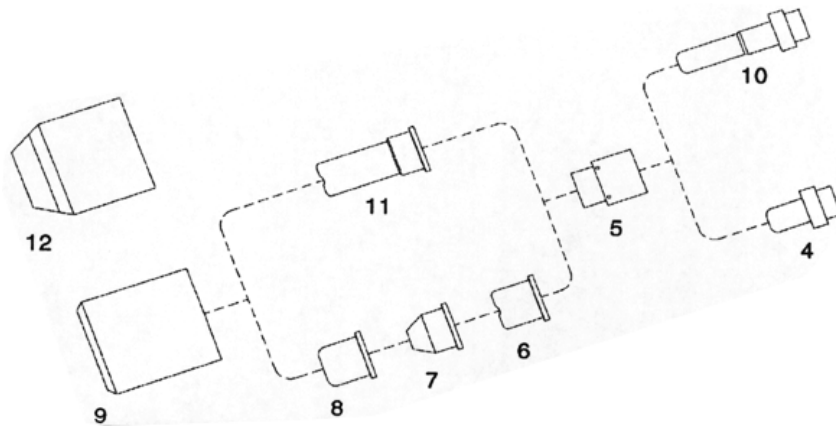
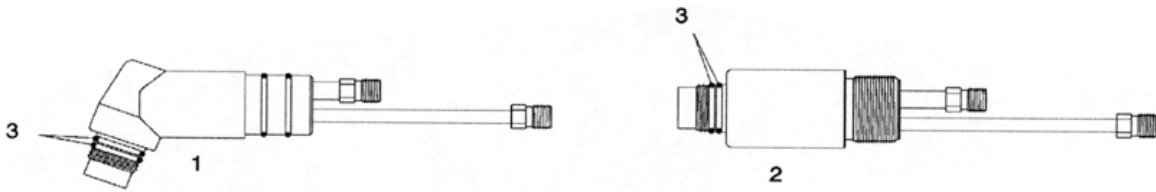

ITEM	CATALOG NUMBER	DESCRIPTION	STD. QTY
N/S	CS057112	HAND TORCH WITH 25' CABLE (1/2 - 20 CONNECTION)	1
N/S	CS057113	HAND TORCH WITH 50' CABLE (1/2 - 20 CONNECTION)	1
N/S	CS07340	MACHINE TORCH WITH 25' CABLE (1/2 - 20 CONNECTION)	1
N/S	CS07350	MACHINE TORCH WITH 50' CABLE (1/2 - 20 CONNECTION)	1
1	CS057114	70° TORCH HEAD W/HANDLE	1
N/S	CS07302	HAND SPARE HANDLE COMPLETE WITH MICROSWITCH	1
2	CS020114	180° TORCH HEAD	1
N/S	CS020206	MACHINE SPARE HANDLE	1
3	CS026016	O-RING	20
4	CS020103	ELECTRODE	10
5	CS020101	SWIRL RING	5
6	CS020115	TIP (CASTLE)	10
7	CS020131	TIP (PIPE)	10
8	CS020102	TIP (MACH)	10
9	CS020104	RETAINING CAP	2
10	CS020467	EXTENDED ELECTRODE	10
11	CS020466	EXTENDED TIP	10
12	CS020200	RETAINING CAP (HI VIS)	2
N/S	CS07380	AIR AND POWER CABLE 25' - HAND TORCH	1
N/S	CS07385	AIR AND POWER CABLE 50' - HAND TORCH	1
N/S	CS07390	AIR AND POWER CABLE 25' - MACHINE TORCH	1
N/S	CS07395	AIR AND POWER CABLE 50' - MACHINE TORCH	1
N/S	CS51853	CIRCLE CUTTING ATTACHMENT	1
N/S	CS51809	CUTTING GUIDE	1

Ergodani is in no way affiliated with HYPERTHERM®. The parts advertised for sale are not genuine HYPERTHERM® parts, but are parts made for and by Ergodani. Reference to HYPERTHERM® machine, torches and numbers are for your convenience only. We reserve the right to substitute genuine HYPERTHERM® parts in place of Ergodani parts.

REPLACEMENT PARTS SUITABLE FOR:

HYPERTHERM®

MAX 100®

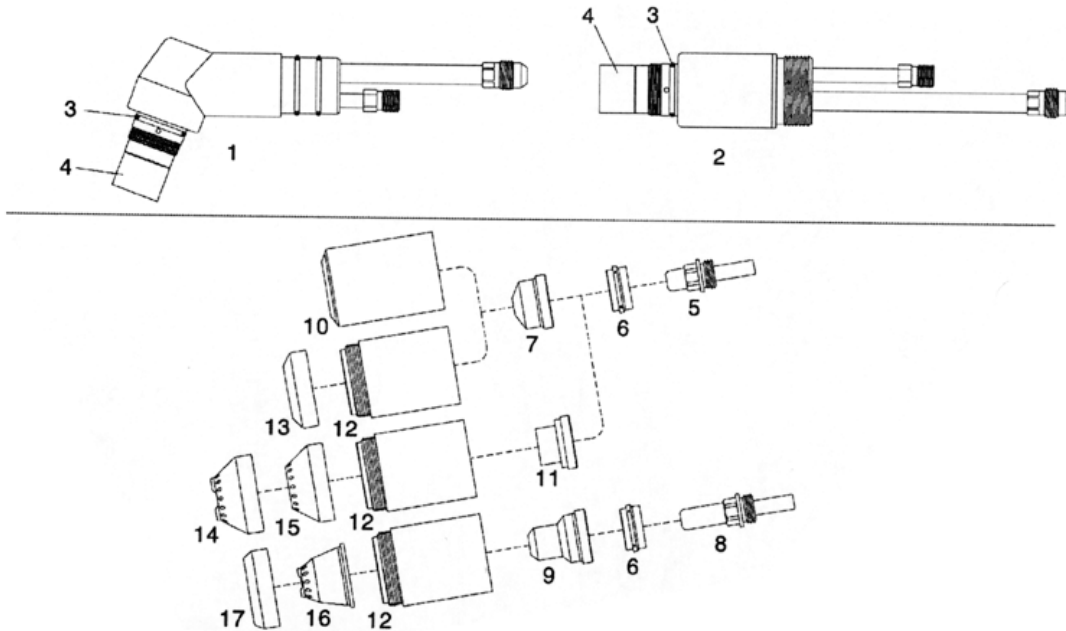

ITEM	CATALOG NUMBER	DESCRIPTION	STD. QTY
N/S	CS059076	HAND TORCH WITH 25' CABLE (1/2 - 20 CONNECTION)	1
N/S	CS059077	HAND TORCH WITH 50' CABLE (1/2 - 20 CONNECTION)	1
N/S	CS07440	MACHINE TORCH WITH 25' CABLE (1/2 - 20 CONNECTION)	1
N/S	CS07450	MACHINE TORCH WITH 50' CABLE (1/2 - 20 CONNECTION)	1
1	CS020189	70° TORCH HEAD W/HANDLE	1
N/S	CS07402	HAND SPARE HANDLE COMPLETE WITH MICROSWITCH	1
2	CS020201	180° TORCH HEAD	1
N/S	CS020245	MACHINE SPARE HANDLE	1
3	CS026018	O-RING	20
4	CS60080	FRONT INSULATOR	2
5	CS120433	ELECTRODE (REPLACES CS020191)	10
6	CS020194	SWIRL RING	5
7	CS020203	TIP 40A	10
	CS020345	TIP 80A	10
	CS020195	TIP 100A	10
8	CS020564	EXTENDED ELECTRODE	10
9	CS51123.10	EXTENDED TIP .038	10
	CS020563	EXTENDED TIP .055	10
10	CS020184	RETAINING CAP	1
11	CS020396	CONTAC TIP 40A	10
	CS020397	CONTAC TIP 80A	10
	CS020337	CONTAC TIP 100A	10
12	CS020336/F	CONTAC SHIELD CAP - FIBER GLASS	1
	CS020336	CONTAC SHIELD CAP - MAX. LIFE	1
13	CS020333	DEFLECTOR	5
14	CS020335	SHIEL CAP (HAND)	2
15	CS020334	SHIEL CAP (MACH)	2
16	CS51980/TD	EXTENDED SHIELD CAP (HAND)	2
17	CS51959/TD	LOCKING NUT	5
N/S	CS60369	EXTRACTOR FOR SWIRL RING	1
N/S	CS07480	AIR AND POWER CABLE 25' - HAND TORCH	1
N/S	CS07485	AIR AND POWER CABLE 50' - HAND TORCH	1
N/S	CS07490	AIR AND POWER CABLE 25' - MACHINE TORCH	1
N/S	CS07495	AIR AND POWER CABLE 50' - MACHINE TORCH	1
N/S	CS51852	CIRCLE CUTTING ATTACHMENT	1
N/S	CS51808	CUTTING GUIDE	1

Ergodani is in no way affiliated with HYPERTHERM®. The parts advertised for sale are not genuine HYPERTHERM® parts, but are parts made for and by Ergodani. Reference to HYPERTHERM® machine, torches and numbers are for your convenience only. We reserve the right to substitute genuine HYPERTHERM® parts in place of Ergodani parts.

REPLACEMENT PARTS SUITABLE FOR:

HYPERTHERM®

MAX 200® / HT-2000®

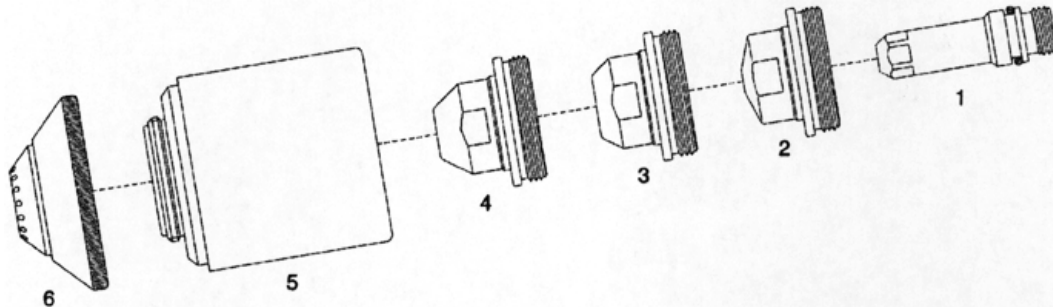

ITEM	CATALOG NUMBER	DESCRIPTION	STD. QTY
1	CS120547	ELECTRODE O ₂ AIR 100A	5
	CS120667	ELECTRODE O ₂ AIR 200A (REPLACES CS020664 AND CS020414)	5
2	CS020689	NOZZLE-AIR 40A .038	5
3	CS020616	NOZZLE-O ₂ 100A .055 (MAX 200® ONLY)	5
	CS020611	NOZZLE-AIR/N ₂ /Ar-H ₂ 100A .059	5
4	CS020608	NOZZLE-AIR/N ₂ /Ar-H ₂ 200A .086	5
	CS020605	NOZZLE-O ₂ 200A .082	5
	CS020690	NOZZLE-O ₂ 100A .055	5
	CS020615	NOZZLE GOUGING AIR 200A	5
5	CS020423	RETAINING CAP	1
6	CS020448	SHIELD CAP 100A	1
	CS020424	SHIELD CAP 200A	1