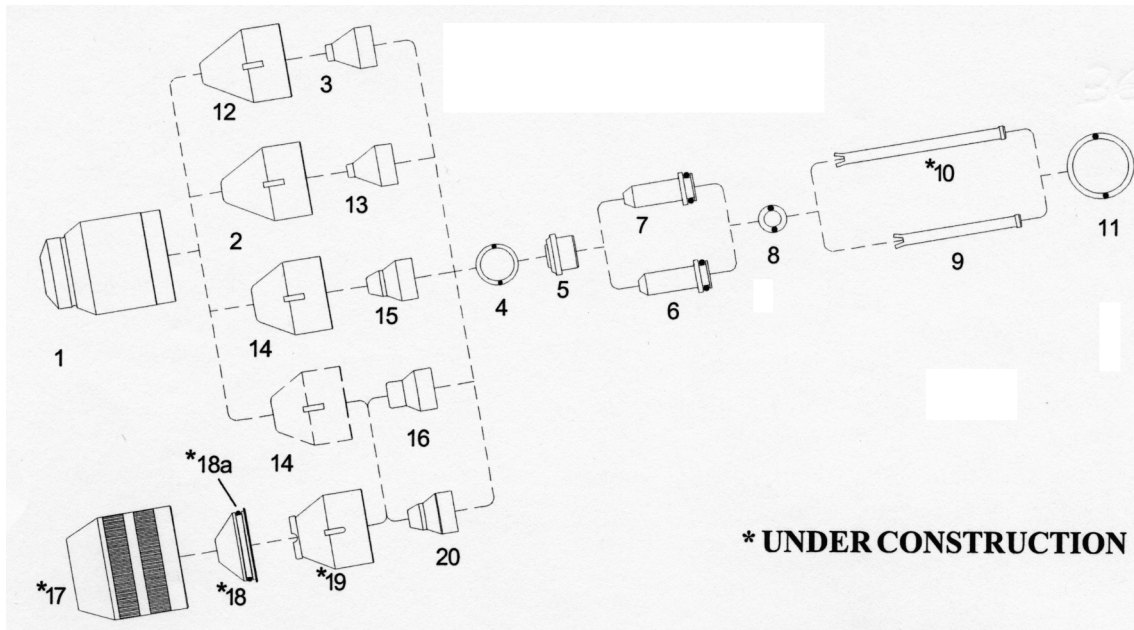

**REPLACEMENT PARTS SUITABLE FOR:**
**KJELLBERG®**

 PB-S40WH/L® / PB-S20W/WH® / PB-S25W/WH® / PB-S40W/WH®  
 PB-S45W/WH® / PB-S45W/WH-1® / PZ-S45W®

**\* UNDER CONSTRUCTION**

ITEM	CATALOG NUMBER	DESCRIPTION	STD. QTY
1	CS11828101160	SHIELD CUP	1
2	CS11828201151	NOZZLE RETAINING CAP Ø6.0	2
3	CS11828201413	NOZZLE LD Ø1.3 AIR	5
	CS11828201414	NOZZLE LE Ø1.4 AIR	5
4	CS10575036	O-RING 12 x 1.5 SILICONE	20
5	CS11828001153	SWIRL RING	2
6	CS118280013001	ELECTRODE KB AIR	5
7	CS118343213001	ELECTRODE KB - X1 O <sub>2</sub> -SOLID SILVER - (REPLACES CS118280213001)	1
	CS118343213001P	ELECTRODE KB - X1 O <sub>2</sub> -SILVER PLATED - (REPLACES CS118280213001)	5
8	CS10505827	O-RING 6 x 2 SILICONE	20
9	CS11828001152	COOLING TUBE	5
10	**11832201152	*COOLING TUBE	-
11	CS10575052	O-RING 20 x 2 SILICONE	20
12	CS11828001151	NOZZLE RETAINING CUP Ø5.0	2
13	CS11828001410	NOZZLE LB Ø1.0 AIR	5
	CS11828001413	NOZZLE LD Ø1.3 AIR	5
14	CS11830301151	NOZZLE RETAINING CUP Ø9.6	2
15	CS11828203410	NOZZLE LLE Ø1.0 AIR	5
	CS11828203413	NOZZLE LDE Ø1.3 AIR	5
	CS11828213414	NOZZLE LEE Ø1.4 AIR	5
16	CS11828302425	NOZZLE LK Ø2.5 AIR	5
	CS11828302430	NOZZLE LN Ø3.0 AIR	5
17	**11832201081	*SHIELD CUP	-
18	**118322011571	*SHIELD Ø4.0	-
18A	**10505911	*O-RING 22 x 1.5 SILICONE	-
19	**11832201160	*NOZZLE RETAINING CUP	-
20	CS11834321410	NOZZLE LLE-X1 Ø1.0 O <sub>2</sub> (REPLACES CS11828223410)	5
	CS11834321413	NOZZLE LDE-X1 Ø1.3 O <sub>2</sub> (REPLACES CS11828223414)	5
	CS11834321414	NOZZLE LEE-X1 Ø1.4 O <sub>2</sub>	5

**REPLACEMENT PARTS SUITABLE FOR:**
**KJELLBERG®**

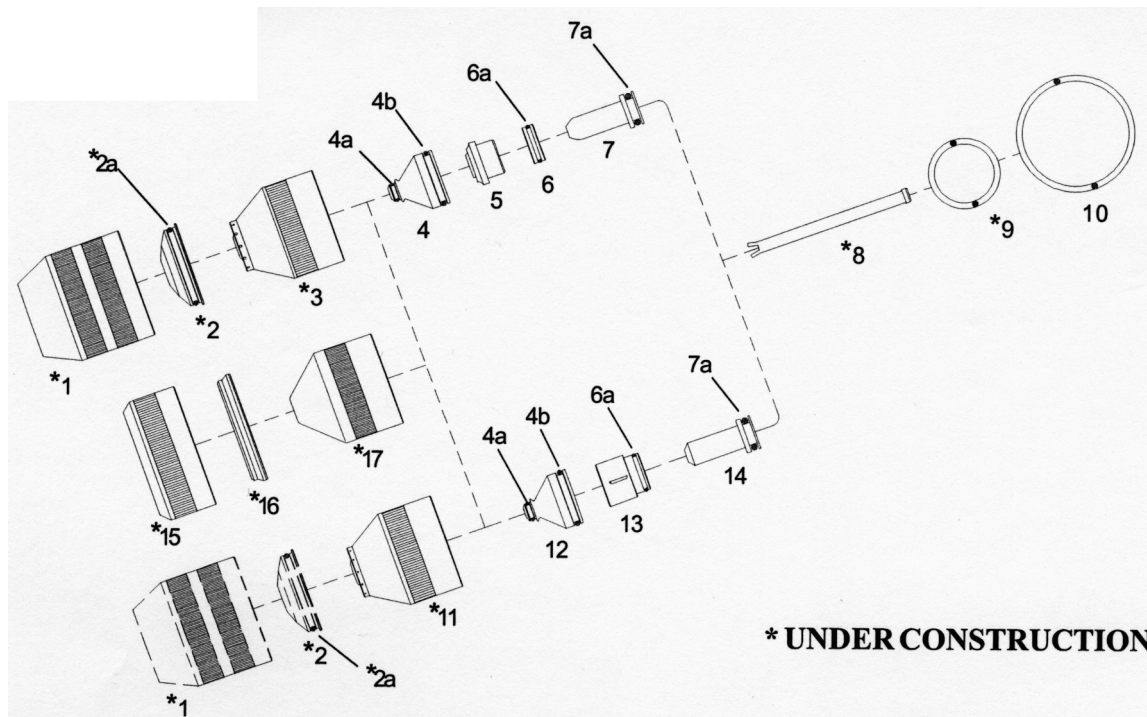
**PERCUT 100®**



ITEM	CATALOG NUMBER	DESCRIPTION	STD. QTY
1	**11835201081	*SHIELD CUP	-
2	**118352011561	*SHIELD Ø1.5	-
	**118352011571	*SHIELD Ø2.0	-
	**118354011571	*SHIELD Ø4.0	-
2a	**10505914	*O-RING 24 x 1.5 SILICONE	-
3	**11835201162	*NOZZLE RETAINING CUP Ø0.8	-
4	CS11835221406	NOZZLE Ø0.6 O <sub>2</sub>	5
	CS11835221407	NOZZLE Ø0.7 O <sub>2</sub>	5
	CS11835221408	NOZZLE Ø0.8 O <sub>2</sub>	5
	CS11835221409	NOZZLE Ø0.9 O <sub>2</sub>	5
	CS11835221410	NOZZLE Ø1.0 O <sub>2</sub>	5
4a	CS10505820	O-RING 4 x 1 SILICONE	20
4b	CS10505885	O-RING 15 x 1.5 SILICONE	20
5	CS11834321153	SWIRL RING	2
6	CS11835421303	SPACER RING	2
6a	CS10505869	O-RING 10 x 1 SILICONE	20
7	CS118354213101	ELECTRODE O <sub>2</sub> X1 ZO12 - SOLID SILVER	1
	CS118354213101P	ELECTRODE O <sub>2</sub> X1 ZO12 - SILVER PLATED	5
7a	CS10505827	O-RING 6 x 2 SILICONE	20
8	**11835201152	*COOLING TUBE PERCUT 100	-
9	**10505946	*O-RING 36 x 2 SILICONE	-
10	CS10575052	O-RING 20x 2 SILICONE	20
11	**11.835.201.160	*NOZZLE RETAINING CUP Ø0.4	-
12	CS11835421412	NOZZLE Ø1.2 O <sub>2</sub>	5
	CS11835421414	NOZZLE Ø1.4 O <sub>2</sub>	5
13	CS11835221153	SWIRL RING	2
14	CS118352213101	ELECTRODE O <sub>2</sub> X1 ZO02 - SOLID SILVER	1
	CS118352213101P	ELECTRODE O <sub>2</sub> X1 ZO02 - SILVER PLATED	5
15	**11835201085	*NOZZLE RETAINING CUP	-
16	**11835201086	*INSULATOR	-
17	**11835201087	*SHIELD CUP	-